

Temporary safety barrier

IBO Wand 500-18

T3/W1

IBO Wand 850-30

H1/W4 & T3/W1

IBO Fence 150

T3/W2

Efficient
Innovative
Reliable

First-class products & best service — all from a single source



IBOTECH



IBO Wand 500-18

T3 W1

Unique extremely narrow width of 18 cm

System width 18 cm Tested according to DIN EN 1317 BASt tested 2019 7E 56

The **IBO Wand 500-18** is one of the most innovative traffic security elements. It combines the two main factors of transportable road barriers: Safety and functionality. Firstly, IBOTECH's mobile safety barrier guarantees a higher level of security in traffic construction sites. And secondly, it is implementable on almost every road due to the very narrow width.

The exceptional feature of the **IBO Wand 500-18** is the narrow structural width of only 18 cm. This makes the road barrier unique compared to competitors. With the successful check by BASt the safety wall fulfills all criteria for a high containment level with the area of influence W1.

Apart from the narrow structural width the **IBO Wand 500-18** is characterized by its low weight. The road barrier is flexibly useable, quickly installed and does not need much space on roads. For the first time a high level of security can be provided also on narrow roads. Because of these features IBOTECH's transportable road barrier 500-18 is matchless in the field of traffic security.

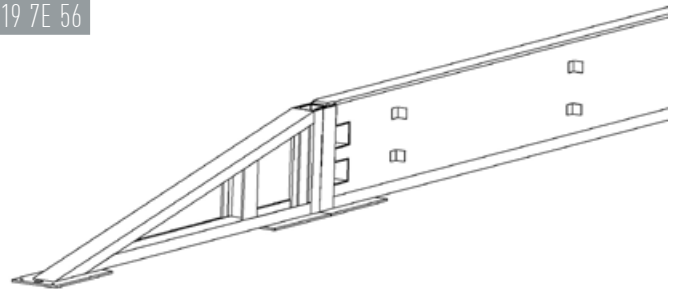

Tested according to DIN EN 1317 (anchored)		
Test	TB 21	TB 41
Containment level	T3	T3
Vehicle type	Car	Truck
Deflection	0.3 m	0.6 m
Area of influence	W1	W1
ASI-value	0,3 (A)	-
Materials	Steel and concrete	Steel and concrete
Height	0.518 m	0.518 m
Length of element	6.00 m	6.00 m
System width	0.18 m	0.18 m
Weight per m	158 kg	158 kg
Ground anchoring	Yes (only at the start)	Yes (only at the start)
Start/end element	none required, optional possible	none required, optional possible
Test length	144 m	144 m

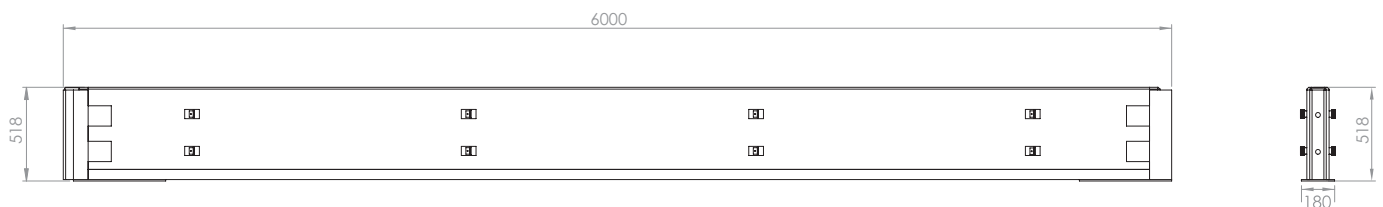

System element – compatible (optional)

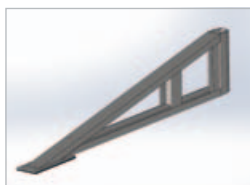

Start/end element



System transition



Dilatation element

IBO Wand 850-30

Two different road barriers in one system

System width 30 cm Tested according to DIN EN 1317 BASt tested 2019 7E 57 / 2019 7E 58

H1 W4

T3 W1

Tested according to DIN EN 1317 (anchored)		
Test	TB 11	TB 42
Containment level	H1	H1
Vehicle type	Car	Truck
Deflection	0.4 m	1.2 m
Area of influence	W2	W4
ASI-value	1.3 (A)	-
Materials	Steel and concrete	Steel and concrete
Height	0.86 m	0.86 m
Length of element	6.00 m	6.00 m
System width	0.30 m	0.30 m
Weight per m	333 kg	333 kg
Ground anchoring	Yes (first & last element)	Yes (first & last element)
Start/end element	none required, optional possible	none required, optional possible
Test length	96 m	96 m

Tested according to DIN EN 1317 (anchored)		
Test	TB 21	TB 41
Containment level	T3	T3
Vehicle type	Car	Truck
Deflection	0.3 m	0.5 m
Area of influence	W1	W1
ASI-value	0.3 (A)	-
Materials	Steel and concrete	Steel and concrete
Height	0.86 m	0.86 m
Length of element	6.00 m	6.00 m
System width	0.30 m	0.30 m
Weight per m	333 kg	333 kg
Ground anchoring	Yes (only at the start)	Yes (only at the start)
Start/end element	none required, optional possible	none required, optional possible
Test length	96 m	96 m

The **IBO Wand 850-30** is made of firstclass concrete and steel. Due to its characteristics the mobile road barrier is perfectly suitable as a traffic leading element for more safety for example in traffic construction sites on highly frequented roads. Because of the special mix of high containment levels, small areas of influence and the narrow width IBOTECHs mobile road barrier is a state-of-the-art traffic safety element.

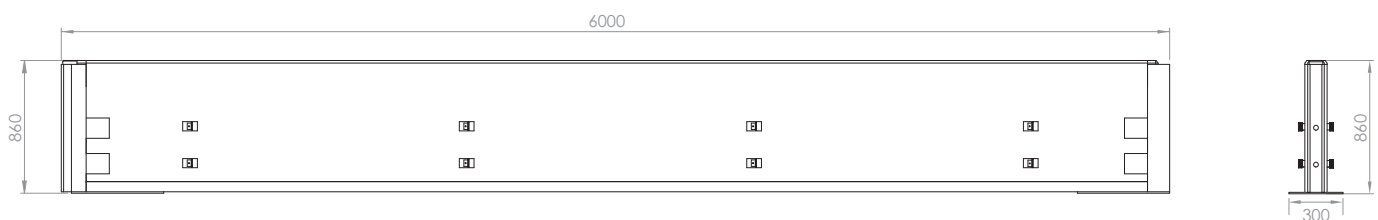

IBO Fence 150

Visibility protection for transportable safety guard

Tested according to DIN EN 1317

T3 W2

The protective visual and safety fence **IBO Fence 150** is adding another component to the product portfolio of the traffic safety expert IBOTECH. The fence can be affixed to IBOTECHs transportable concrete barriers.

The **IBO Fence 150** is already successfully tested for the European standard DIN 1317, the containment level T3 and the area of influence W2 for transportable safety barriers in road traffic.

Tested according to DIN EN 1317 (unanchored)		
Test	TB 21	TB 41
Containment level	T3	T3
Vehicle type	Car	Truck
Deflection	0.3 m	0.7 m
Area of influence	W1	W2
ASI-value	0.3 (A)	-
Materials	Steel and concrete	Steel and concrete
Height	1.50 m	1.50 m
Length of element	6.00 m	6.00 m
System width	0.30 m	0.30 m
Weight per m	355 kg	355 kg
Ground anchoring	No	No
Setup	unanchored on asphalt/concrete	unanchored on asphalt/concrete
Start/end element	none required, optional possible	none required, optional possible
Test length	96 m	96 m

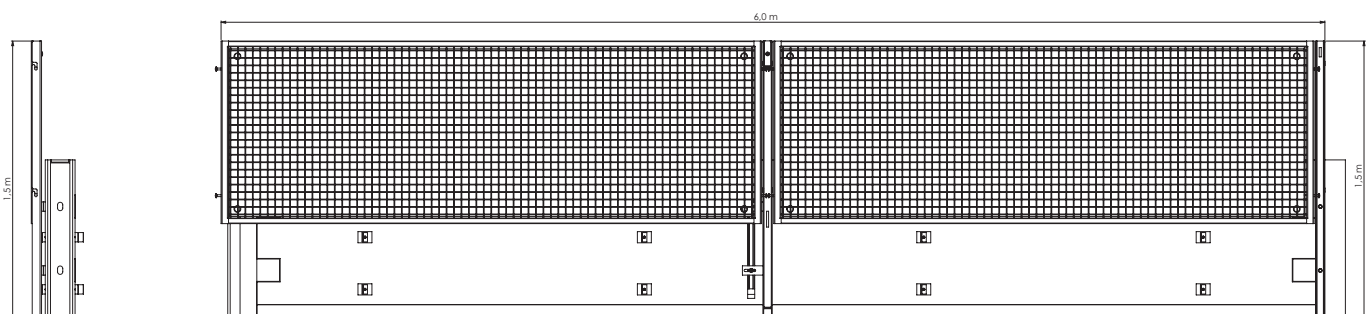

Safety is our mission.
Efficiency is our passion.
Innovation our **signature**.

